



# LZ Series - LZS2

## Vaportight Standard 2' Body

### 2,000 - 8,000 Lumens

Project:

Location:

Cat.No:

Notes:

#### Product Description

The LZ Series Standard Body 2' fixture is a proven vaportight LED designed for applications requiring extensive coverage on low to high ceilings. This versatile unit offers multiple lumen packages and mounting configurations, featuring various latch and lens options to suit specific requirements. The casing is manufactured in the USA with durable construction and thick sealing for superior performance in dusty or wet environments, accommodating installation heights from 8 to 14 feet. Final assembly in Ontario, Canada ensures meticulous craftsmanship, making it the reliable lighting solution for your most demanding projects.

#### Application

This unit excels in industrial, commercial, and agricultural settings where protection against water and dust is essential. It performs exceptionally in demanding applications including washbays, dairy barns, sheep barns, horse barns, pig barns, welding facilities, concrete plants, car washes, and numerous other challenging environments, making it an exceptional choice for the most demanding conditions.

#### Features

- Configurations exceeding 140 lm/w.
- Standard 0-10V dimming for control/precision.
- High-performance LED boards manufactured in-house.

#### Options

- Wide range of lumen outputs to meet diverse requirements.
- Variety of lens options available.
- Customizable color temperature and CRI values for optimal lighting.
- Pre-wired whips (specify in ordering code if required).

#### Mounting

- Surface - mounts directly to any ceiling or wall.
- Suspension - chain hangers available as additional option.

Approved for use in Canada and USA, QPS certified. Includes standard 5-year warranty—view our warranty policy for complete details.

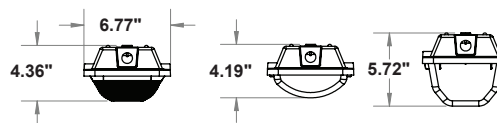
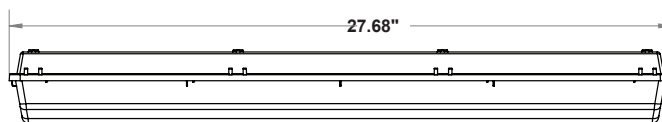

NEMA 4X



5 YEAR  
WARRANTY



#### Ordering Guide Example: LZS4-8C40K178L-347D1NW-FRPMMB

CRI	CCT	Lumens	Voltage	Driver	0-10V Wiring	Lens	Latches	Mounting
8C 80	30K 3000K	080L 8,000	UNV 120-277V	D1 0-10V 1%	NW Not Wired for DIM	CR Clear Ribbed	PM POM (Nylon)	MB Surface/Chain Mount Brackets
9C 90	40K 4000K	060L 6,000	347 347V		PW Pre-Wired for DIM	FR Frosted Ribbed	SS Stainless Steel	WD 45° Mount Bracket
	50K 5000K	040L 4,000				CS Clear Smooth		NM No Mount Bracket's
	65K 6500K	020L 2,000				FS Frosted Smooth		

#### Options

Blank	None
RTP	Retail Packaging
CD2	2' Whip Pre-Wired (Black)
CD3	3' Whip Pre-Wired (Black)
SN1	PIR Motion Sensor (IP66)

#### Specification Chart

Lumens	Watts	Clear Ribbed	Frosted Ribbed	Color	CRI
8,000	56	8,687	8,513	5000K	80
6,000	40	6,200	6,076	5000K	80
4,000	30	4,700	4,606	5000K	80
2,000	15	2,360	2,313	5000K	80

Testing based on 25°C ambient temperature. Nominal calculations—actual outputs may vary based on product configurations. We reserve the right to correct printing errors or mistakes in our specifications.

All information on this sheet is for informational use and may not be changed or edited without approval from JW LED Inc. We reserve the right to correct printing errors or modify specifications without prior notice.