

OVERVIEW

The 360° Snap Fit sensor is a compact line voltage sensor that snaps directly into a small cavity in a fixture. The sensor utilizes Passive Infrared (PIR) detection to detect motion from occupants within its 360° coverage pattern that overlaps that of most HID, T-5, T-8, or LED fixtures used in high bay or low bay applications.

SENSOR OPERATION

The sensor detects changes in the infrared energy given off by occupants as they move within the field-of-view. When occupancy is detected, a self-contained relay switches the connected lighting load on. The sensor is line powered, switches line voltage, and requires no field calibration or sensitivity adjustments.

LAMPMAXIMIZER®

This sensor also contains patented LampMaximizer technology that allows users to aggressively target energy savings while still protecting lamp life. A minimum on timer, factory set at 15 minutes, helps preserve lamp life by eliminating all lamp cycles shorter than lamp manufacturers’ recommendations.

A standard occupancy time delay is also present that ensures lights turn off (assuming minimum on timer has elapsed) if no occupancy is detected. This timer is factory set at 10 minutes to promote energy savings, but is adjustable between 30 seconds and 30 minutes. These adjustments can be done manually, through the unit’s push-button; no tools required.

FEATURES

- Self-Contained Relay, No Power Pack Needed
- No Minimum Load Requirements
- Interchangeable Hot & Load Wires, Impossible to Wire Backwards
- Push-Button Programmable
- Adjustable Time Delays
- No Field Calibration or Sensitivity Adjustments Required
- Convenient Test Mode
- 100 hr Lamp Burn-in Timer

Warranty

Five-year limited warranty. This is the only warranty provided and no other statements in this specification sheet create any warranty of any kind. All other express and implied warranties are disclaimed. Complete warranty terms located at: [www.acuitybrands.com/support/warranty/terms-and-conditions](http://www.acuitybrands.com/support/warranty/terms-and-conditions)

**Note:** Actual performance may differ as a result of end-user environment and application. Specifications subject to change without notice



SFR 45  
360° Sensor



ORDERING INFORMATION

SFR 45			Example: SFR 45 LT	
Series		Voltage	Temperature / Humidity	
SFR 45 Snap Fit Enclosure		[blank] 120/277 VAC	[blank] Standard	LT Low Temp
		347 347 VAC		

## COVERAGE PATTERN

Lens rotates 15 deg to enable adjustment. Initial detection will occur earlier when walking across sensor's field of view than when walking directly at sensor.

### 45 - HIGH MOUNT 360°

- Optimized full coverage pattern for 10 – 40 ft. (3.1 – 12 m)
- Reliable detection of large motion (e.g. pedestrian walking traffic) up to 30 ft. (9.1 m) mounting height
- Reliable detection of extra-large motion (e.g. forklift traffic) up to 40 ft. (12 m) mounting height

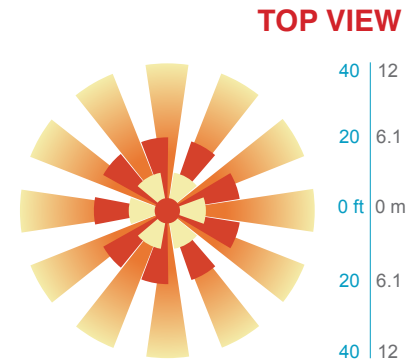
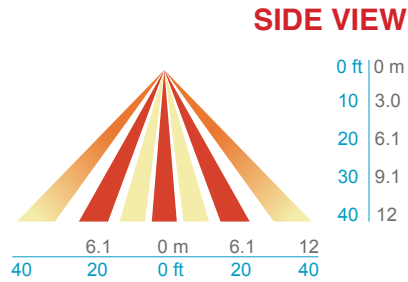

## WIRING (DO NOT WIRE HOT)

### STANDARD WIRING

BLACK\* - Line Input  
BLACK\* - Load Output  
WHITE - Neutral

\*BLACK wires can be reversed

### 347 VAC OPTION

Black wires are replaced w/ Red wires

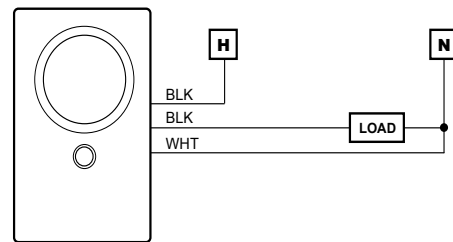

### INITIAL POWER UP

The sensor's relay is shipped in a latched closed position so the lights will come on upon initial power-up. If the lights do not immediately turn on (initial installation only) the latching relay opened during shipment and will close within 30 secs.

**Note:** If the sensor loses power, the internal relay will latch to on.

## INSTALLATION

### MOUNTING

- The snap fit enclosure is designed to fit snugly inside a 2 3/16" H x 1 5/16" W x 1" D cavity in a luminaire.

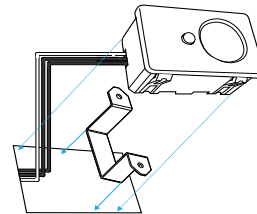
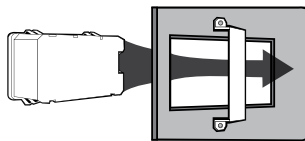
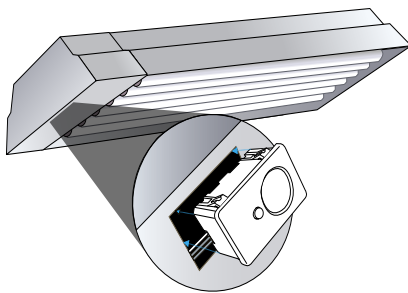

Diagrams show internal cross section of fixture with bracket included for additional sensor impact strength.

- For optimal detection, position sensor such that segments are crossed upon entrance and unable to view outside the space

### PROGRAMMING

Refer to instruction card IC1-002 for default settings and directions on programming the sensor via the push-button.

SPECIFICATIONS

Electrical	Input Ratings	120VAC, 6.6A, 50/60 Hz 277VAC, 4.3A, 50/60 Hz 347VAC, 4.3A, 50/60 Hz
	Output Ratings	120VAC , 800W, 6.7A - Tungsten, Standard Ballast, Electronic Ballast 277VAC , 1200W, 4.3A - Tungsten, Standard Ballast, Electronic Ballast 347VAC, 1500W, 4.3A - Tungsten, Standard Ballast, Electronic Ballast 120, 1/4 HP - Motor (5.8A FLA, 34.8 LRA) 277, 1/4 HP - Motor (2.4A FLA, 14.4 LRA) 347VAC, (0.5 FLA, 3LRA)
	Relay Type	Latching
	Standards/ Ratings	Energy Management Equipment, UL916 (E167435)
Mechanical	Dimensions	2.25"H x 1.38"W x 0.82" D
	Mounting	Snaps into 2 3/16"H x 1 5/16"W x 1" D cavity in fixture
	Color	White
	Connection Type	Line-Voltage Leads
Environmental	Warrantied Operating Temperature	Standard: 14°F to 140°F (-10°C to 60°C) LT option: -4°F to 140°F (-20°C to 60°C)
	Relative Humidity	Up to 90%, Non-Condensing
	Standards/ Ratings	RoHS, Energy Management Equipment, UL916 (E167435)