



LZ Series - LZN4

Vaportight Narrow 4' Body

2,000 - 8,000 Lumens

Project:

Location:

Cat.No:

Notes:

Product Description

The LZ Series Narrow Body 4' fixture is a sleek, low-profile vaportight LED designed for applications requiring extensive coverage on medium to low ceilings. This versatile unit offers multiple lumen packages and mounting configurations, featuring various latch and lens options to suit specific requirements. The casing is manufactured in the USA with durable construction and thick sealing for superior performance in dusty or wet environments, accommodating installation heights from 8 to 14 feet. Final assembly in Ontario, Canada ensures meticulous craftsmanship, making it the reliable lighting solution for your most demanding projects.

Application

This unit excels in industrial, commercial, and agricultural settings where protection against water and dust is essential. It performs exceptionally in demanding applications including washbays, dairy barns, sheep barns, horse barns, pig barns, welding facilities, concrete plants, car washes, and numerous other challenging environments, making it an exceptional choice for the most demanding conditions.

Features

- Configurations exceeding 140 lm/w.
- Standard 0-10V dimming for control/precision.
- High-performance LED boards manufactured in-house.

Options

- Wide range of lumen outputs to meet diverse requirements.
- Variety of lens options available.
- Customizable color temperature and CRI values for optimal lighting.
- Pre-wired whips (specify in ordering code if required).

Mounting

- Surface - mounts directly to any ceiling or wall.
- Suspension - chain hangers available as additional option.

Approved for use in Canada and USA, QPS certified. Includes standard 5-year warranty—view our warranty policy for complete details.

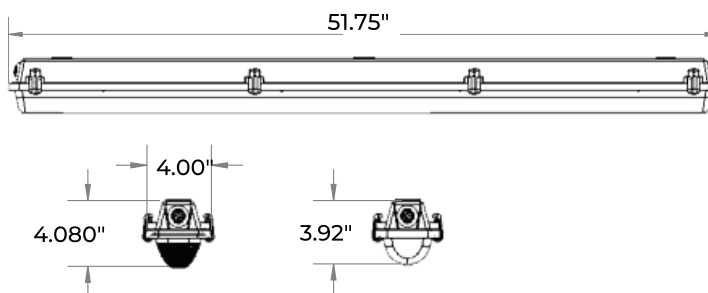

NEMA 4X



5 YEAR
WARRANTY



Ordering Guide Example: LZN4-8C40K055L-UNVD1NW-FRPMMB

CRI	CCT	Lumens	Voltage	Driver	0-10V Wiring	Lens	Latches	Mounting
8C 80	30K 3000K	080L 8,000	UNV 120-277V	D1 0-10V 1%	NW Not Wired for DIM	CR Clear Ribbed	PM POM (Nylon)	MB Surface/Chain Mount Brackets
9C 90	40K 4000K	055L 5,500	347 347V		PW Pre-Wired for DIM	FR Frosted Ribbed	SS Stainless Steel	NM No Mount Bracket's
	50K 5000K	040L 4,000				CS Clear Smooth		
	65K 6500K	020L 2,000				FS Frosted Smooth		

Options

- Blank** None
- RTP** Retail Packaging
- CD2** 2' Whip Pre-Wired (Black)
- CD3** 3' Whip Pre-Wired (Black)



SCAN FOR TECHNICAL
AND IES FILES

Specification Chart

Lumens	Watts	Clear Ribbed	Frosted Ribbed	Color	CRI
8,000	56	8,929	8,750	5000K	80
5,500	37	6,280	6,154	5000K	80
4,000	27	4,740	4,645	5000K	80
2,000	14	2,400	2,352	5000K	80

Testing based on 25°C ambient temperature. Nominal calculations—actual outputs may vary based on product configurations. We reserve the right to correct printing errors or mistakes in our specifications.

All information on this sheet is for informational use and may not be changed or edited without approval from JW LED Inc. We reserve the right to correct printing errors or modify specifications without prior notice.